

# Sydney Port Botany Terminal 3

## Monthly Environmental Monitoring Report

### February 2014

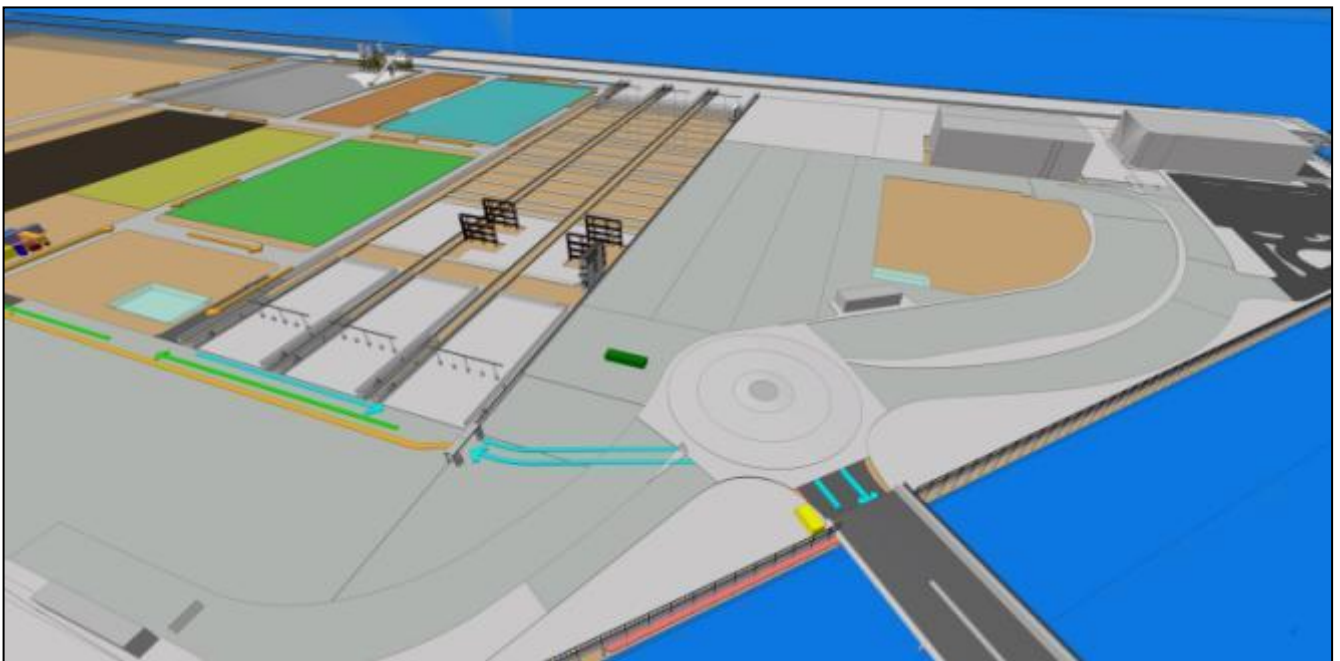



Client:	SICTL
Client's Representative:	Mott McDonald
LORA Contract No.:	G52

Controlled Copy no.: 1

**Revision History**

Rev	Date	Description	Reviewed	INT/Date	Authorised
0	03/03/14	Issue	JA	03/03/14	JA

# SPBT3 Monthly Environmental Monitoring Report – February 14

## Contents:

<b>1.0</b>	<b>Introduction</b> .....	<b>4</b>
1.1	Construction Activities.....	4
<b>2.0</b>	<b>Dust Monitoring and Air Quality</b> .....	<b>4</b>
<b>3.0</b>	<b>Noise Monitoring</b> .....	<b>4</b>
3.1	Day time noise monitoring .....	4
<b>4.0</b>	<b>Water Quality Monitoring</b> .....	<b>5</b>
4.1	Water Monitoring.....	5
<b>5.0</b>	<b>Shorebird Monitoring</b> .....	<b>5</b>
<b>6.0</b>	<b>Environmental Inspections and Audits</b> .....	<b>5</b>
<b>7.0</b>	<b>Appendices</b> .....	<b>6</b>
	<b>Appendix 1 – Dust Monitoring Results</b> .....	<b>7</b>
	<b>Appendix 2 – February 2014 Day Noise Monitoring Results</b> .....	<b>10</b>
	Noise Monitoring Locations.....	11
	<b>Appendix 3 – February 2014 Dewatering Results</b> .....	<b>12</b>

## **1.0 Introduction**

This report provides results for environmental monitoring activities associated with the Laing O'Rourke Terminal 3 expansion work at Port Botany for the month of February 2014.

As Laing O'Rourke works are drawing to a close and construction activities have reduced, monitoring has primarily been undertaken for air quality and noise.

No environmental complaints have been received by Laing O'Rourke this month in regards to the Terminal 3 construction works.

### **1.1 Construction Activities**

Laing O'Rourke construction activities undertaken for the month of November 2013 included the following:

- Earthworks and spoil removal
- Services works
- Concrete batch plant and paving operations
- Rail beam preparation and construction
- Ballast deliveries
- Landscaping

## **2.0 Dust Monitoring and Air Quality**

Four dust deposition gauges are installed in the areas surrounding the Port Botany Expansion. Dust deposition results for February 2014 have yet to be received from our laboratory. January 2014 results are reported in Appendix 1.

All results received for the deposition gauges are within EPA guidelines and Project criteria. After recent dust exceedances adjacent the works, Laing O'Rourke water cart operations have been focussed on active work sites to ensure dust levels are kept below the project targets.

No residential properties or road networks have been impacted by dust emanating from the Port expansion construction works and there have been no dust complaints received by the project during this monitoring period.

A real-time dust monitor has been installed at the Botany Golf Club for reporting of PM<sub>10</sub> particulate matter. No exceedances of project PM<sub>10</sub> particulate matter criteria were recorded during February 2014. Technical issues were encountered on 24<sup>th</sup> January 2014 with a fault in the satellite communication system. PM<sub>10</sub> data was not able to be regained until 10<sup>th</sup> February 2014.

Dust and PM<sub>10</sub> monitoring results are outlined in Appendix 1.

## **3.0 Noise Monitoring**

Monthly construction noise monitoring was undertaken during February 2014. Noise monitoring locations have been based on noise-sensitive receptors in the project Environmental Impact Statement and approved for the Port Botany Expansion construction activities.

Attended noise measurements were carried out for a period of 15 minutes at each location. During the monitoring event, observations were made on the weather as well as the surrounding noise sources and environment.

### **3.1 Day time noise monitoring**

Noise measurements were undertaken on 24<sup>th</sup> February 2014. Work activities being undertaken on the Terminal 3 project included earthworks, rail installation, services activities, batch plant operation, rail beam construction, and material transport.

## SPBT3 Monthly Environmental Monitoring Report – February 14

The Interim Construction Noise Guideline (2009, DECCW) sets out management levels for noise at residences and how they are to be applied. This guideline has been used in conjunction with the project Environmental Impact Statement to determine noise goals for the project. Recorded LA<sub>eq</sub> levels exceeded the noise goals for noise emissions from the Port Botany Expansion Project all 6 monitoring locations, however at each monitoring location extraneous, non-project related noises were the dominant noise sources. These noise sources included road traffic, both local and main, and aircraft noise. No Terminal 3 construction activities were audible at any monitoring locations.

It is noted that the intent of the Interim Construction Noise Guideline is to minimise noise impact from the construction works and is only applicable to the contribution of the noise from the Port Botany construction site. At the attended monitoring events, as has been noted on other stages of the Port Botany expansion project, the measured noise levels were controlled and dominated by other extraneous noise sources as listed above.

Noise monitoring results are shown in Appendix 2.

### 4.0 Water Quality Monitoring

Physical water parameters required to be monitored are pH, turbidity and visible oil and grease when dewatering activities are undertaken. Other contaminants may be tested for in areas of concern if the presence of contamination is observed.

#### 4.1 Water Monitoring

Dewatering activities took place during February 2014 after heavy rainfall. All dewatering was within project criteria. Results of Laing O'Rourke dewatering activities on the Terminal 3 site during February 2014 are shown in Appendix 3.

### 5.0 Shorebird Monitoring

No shorebird observations were obtained this month. With the noise wall installed around the perimeter of the site, birds present in Penrhyn Estuary cannot be seen and no target bird species have been identified on site. Sydney Ports Corporation manages Penrhyn Estuary and report on findings and progress separately to the Terminal 3 construction works.

### 6.0 Environmental Inspections and Audits

Weekly environmental inspections have been undertaken during February 2014 for the Terminal 3 project site. Inspections have focused on dust suppression with hot and dry conditions through the first half of the month. No significant environmental issues were observed or identified.

## **7.0 Appendices**

- Appendix 1 – Dust Monitoring Results**
- Appendix 2 – Noise Monitoring Results**
- Appendix 3 – Dewatering Results**

# SPBT3 Monthly Environmental Monitoring Report – February 14

## Appendix 1 – Dust Monitoring Results

### Dust Deposition Gauge Results - January 2014

No.	Monitoring Location	Ash	Combustible matter	Total Soluble matter	Total Insoluble matter	Total Solids	Sample ID (File Reference)	EPA Guideline (Total Insoluble matter)	Comments (i.e. any exceedances of EPA objectives)	Work Activities / Observations During Monitoring Period
1	Upper Penrhyn Estuary	1.6	0.7	1.7	2.3	4.0	EN1400429-003	4.0	Within EPA guideline levels	Earthworks Deliveries Concrete batch plant Paving Rail Beam Landscaping Ballast deliveries
2	Joseph Banks Park	0.4	0.6	0.6	1.0	1.6	EN1400429-001	4.0	Within EPA guideline levels	
3	Purcell Park	0.7	0.6	1.0	1.3	2.3	EN1400429-002	4.0	Within EPA guideline levels	
4	Botany Golf Course	0.5	0.6	0.4	1.1	1.5	EN1400429-004	4.0	Within EPA guideline levels	

All Units in g/m<sup>2</sup>.month

SPBT3 Monthly Environmental Monitoring Report – February 14

PM<sub>10</sub> Monitoring Results – February 2014

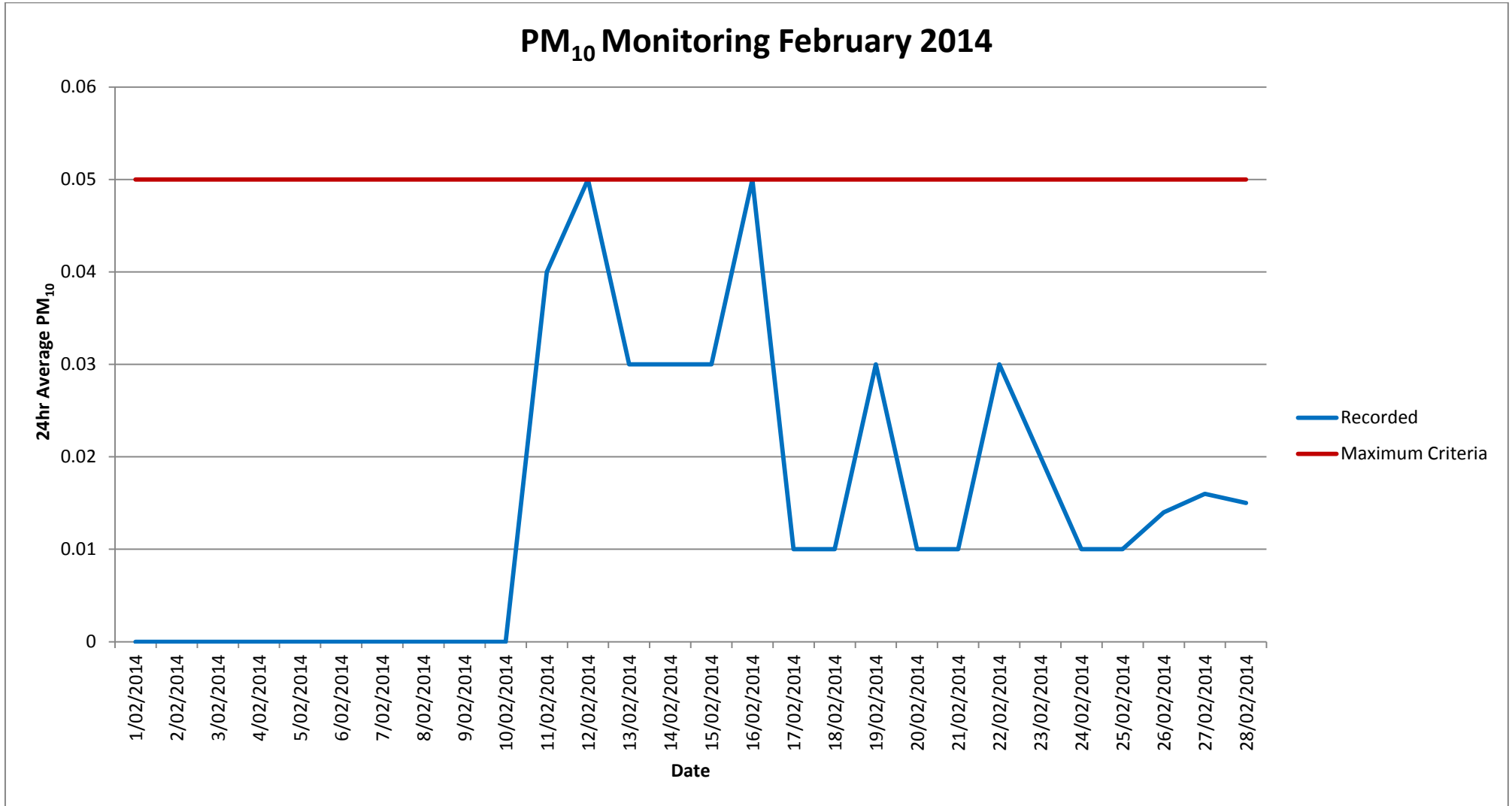



# SPBT3 Monthly Environmental Monitoring Report – February 14

## Dust Monitoring Locations



SPBT3 Monthly Environmental Monitoring Report – February 14

Appendix 2 – February 2014 Day Noise Monitoring Results

Noise Sensitive Area	Monitoring Location	Date	Time (24hr) & Duration (mins)	Construction Activities	Standard or Out of Hours Works (Day/Evening/Night)	Weather Conditions	In Response to Complaint?	RBL (dBA) - from EIS	Noise Goal <sup>1</sup> (RBL+ 5dBA)	Recorded Noise Level LAeq (15 min) (dBA)	Recorded Noise Level LA1 (dBA)	Recorded Noise Level LA10 (dBA)	Recorded Noise Level L90 (dBA)	Noise Goal Difference (dBA)	Comments
Location 1 - Chelmsford Avenue	14 The Esplanade	24/02/2014	10:45	Material deliveries Batch Plant Pavement Works Rail Beam Construction	Standard Day	Fine	No	49	54	64	74	68	52	10	Noise from Foreshore Rd traffic, aircraft noise, local traffic, Residential construction main noise source.park noise. Terminal 3 construction inaudible
Location 2 - Dent Street	34 Dent St	24/02/2014	9:45	Material deliveries Batch Plant Pavement Works Rail Beam Construction	Standard Day	Fine	No	47	52	56	62	59	52	4	Local traffic and foreshore road noise, aircraft noise, park noise. Terminal 3 construction inaudible
Location 3 - Jennings Street	42 Jennings St	24/02/2014	12:00	Material deliveries Batch Plant Pavement Works Rail Beam Construction	Standard Day	Fine	No	40	45	56	67	59	41	11	Local traffic noise, aircraft noise. Terminal 3 construction inaudible
Location 4 - North of Golf Course	3 Anniversary Rd	24/02/2014	10:15	Material deliveries Batch Plant Pavement Works Rail Beam Construction	Standard Day	Fine	No	57	62	64	74	62	50	2	Local traffic noise, aircraft noise. Terminal 3 construction inaudible
Location 5 - Australia Avenue	74 Australia Ave	24/02/2014	11:30	Material deliveries Batch Plant Pavement Works Rail Beam Construction	Standard Day	Fine	No	42	47	53	63	57	45	6	Local/distant traffic noise, aircraft noise, local industry. Terminal 3 construction inaudible
Location 6 - Military Road	73 Wassell St	24/02/2014	12:30	Material deliveries Batch Plant Pavement Works Rail Beam Construction	Standard Day	Fine	No	46	51	55	59	58	52	4	Noise from Bunnerong Rd, Local traffic noise, local industry, adjacent park. Terminal 3 construction inaudible

Note 1: Noise goals are applicable to the noise contribution from the Terminal 3 Port Botany Expansion related construction activities only

SPBT3 Monthly Environmental Monitoring Report – February 14

Noise Monitoring Locations



Location 1	Location 2	Location 3	Location 4	Location 5	Location 6
14 The Esplanade	34 Dent St	42 Jennings St	3 Anniversary Rd	74 Australia Ave	73 Wassell St

## SPBT3 Monthly Environmental Monitoring Report – February 14

## Appendix 3 – February 2014 Dewatering Results

Dewatering Location	Date	AM/PM	Meets Criteria	Discharge Location	Oil and Grease (visual)	Horiba Water Monitor	
						pH	Turbidity
SC9	20-Feb	9:00AM	Yes	Terminal Stormwater	No	8.50	13.0
SC10	20-Feb	9:20AM	Yes	Terminal Stormwater	No	8.45	22.8